

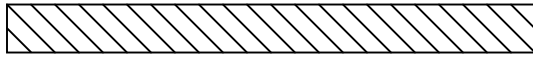

Submittal Data

Single Wall Oval



Spiral Pipe

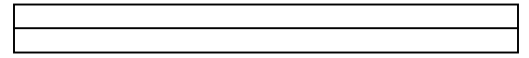

Longitudinal Seam Pipe

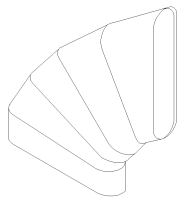

Hard Bend

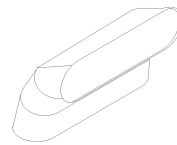

Easy Bend

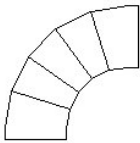

Gored 90° Elbow

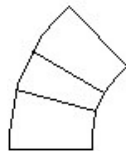

Gored 45° Elbow



Gored 60° Elbow

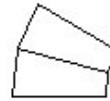

Gored 30° Elbow



Gored 22 1/2° Elbow

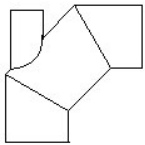

90° Elbow
with Heel Tap

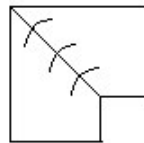

Square Throat
90° Elbow

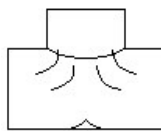

Bullhead Tee

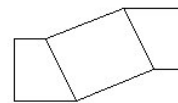

Offset

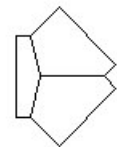

True Wye

Northeastern Sheet Metal, Inc.

PO Box 246 - 31 Depot Street - Goffstown, NH 03045

(603) 497-4166 – fax (603) 497-8518

Single Wall Oval

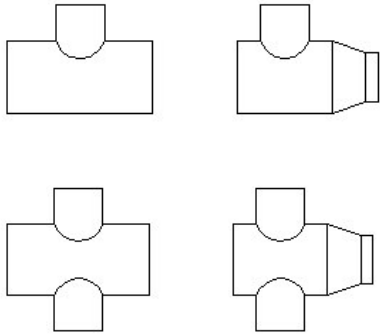

Fittings with 90° Straight Taps

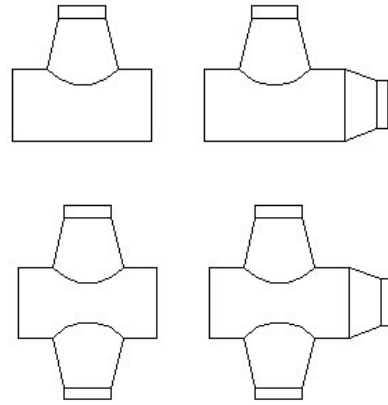

Fittings with 90° Conical Taps

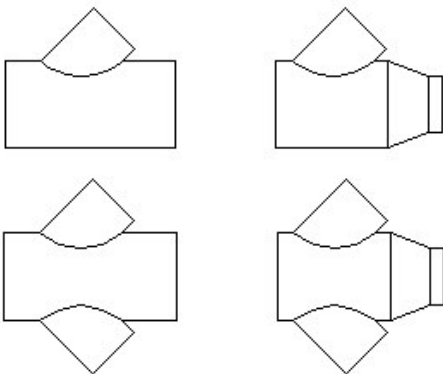

Fittings with 45° Straight Taps

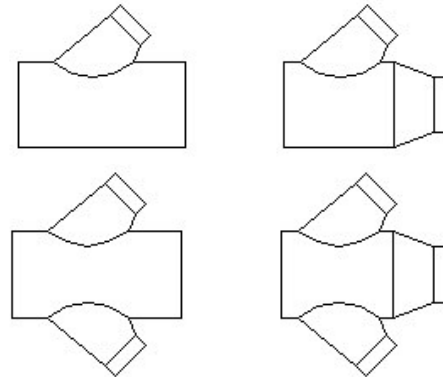

Fittings with 45° Conical Taps

Northeastern Sheet Metal, Inc.

PO Box 246 - 31 Depot Street - Goffstown, NH 03045

(603) 497-4166 – fax (603) 497-8518

Single Wall Oval

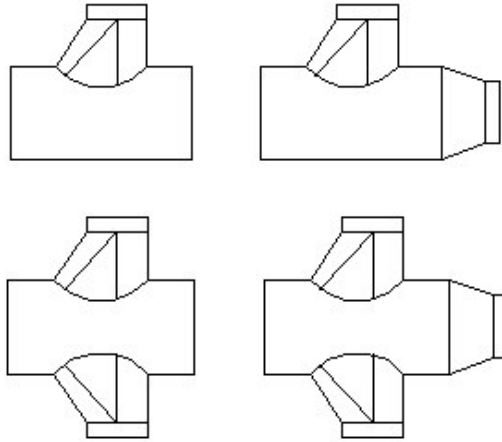

Fittings with Combination Taps

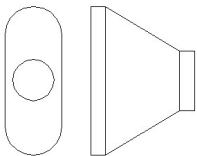

Oval to Round
Concentric
Transition

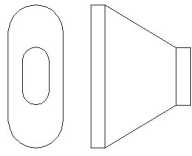

Oval to Oval
Concentric
Transition

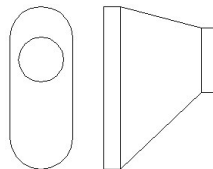

Oval to Round
Non-Concentric
Transition

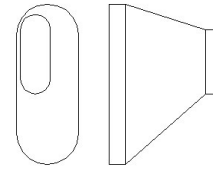

Oval to Oval
Non-Concentric
Transition

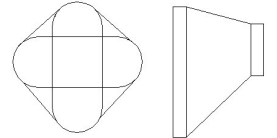

Oval to Oval Twist
Transition

Northeastern Sheet Metal, Inc.

PO Box 246 - 31 Depot Street - Goffstown, NH 03045

(603) 497-4166 – fax (603) 497-8518



Submittal Data

Single Wall Oval

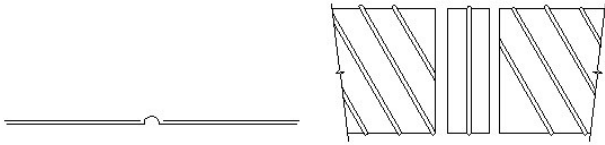

Pipe to Pipe - Male Coupling

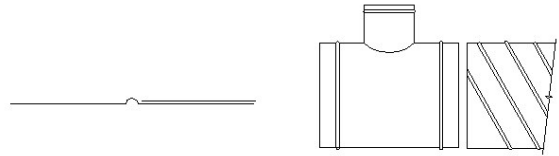

Pipe to Fitting - Male to Female

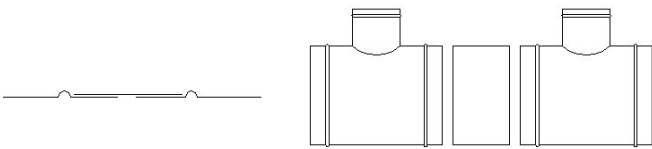

Fitting to Fitting - Female Coupling

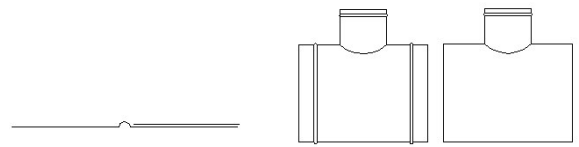

Fitting to Fitting - Male to Female

Northeastern Sheet Metal, Inc.

PO Box 246 - 31 Depot Street - Goffstown, NH 03045

(603) 497-4166 - fax (603) 497-8518